

NOTES :

1. PROVIDE (2) 4 X 3/2 X 5/16 STL. ANGLE LINTEL WITH 8" MIN. BEARING ON EACH END.
2. PROVIDE (2) 3/2 X 3/2 X 5/16 STL. ANGLE LINTEL WITH 8" MIN. BEARING ON EACH END.
3. PROVIDE (2) 6 X 4 X 3/8 STL. ANGLE LINTEL WITH 8" MIN. BEARING ON EACH END.

WALL PARTITION KEY :

- P1 3/4" GYP. BD BOTH SIDES, 3-5/8" MTL. STUDS (6" STUDS AT KITCHEN), 24" O.C. STUDS AND SOUND INSULATION TO EXTEND TO METAL DECK. GYP. BD. TO EXTEND TO 6" ABOVE CEILING OR TO DECK WHERE NO CEILING.
- P2 SAME AS P1 WITHOUT SOUND INSULATION
- P3 INSTALL RESILIENT CHANNELS, 24" O.C. AND ONE ADDITIONAL LAYER 5/8" GYP. OVER EXISTING PARTITION (AND NEW PARTITION SECTIONS AT CORRIDOR 135)
- P4 SAME AS P2 WITH MOISTURE RESISTANT GYP. BD. ON BOTH SIDES.
- P5 SAME AS P1 WITH MOISTURE RESISTANT GYP. BD. ON "WET" SIDE. EXTEND WALL TO FLOOR DECK ABOVE.

////// NEW PARTITIONS

===== SIDE OF WALL WITH P3 FINISH

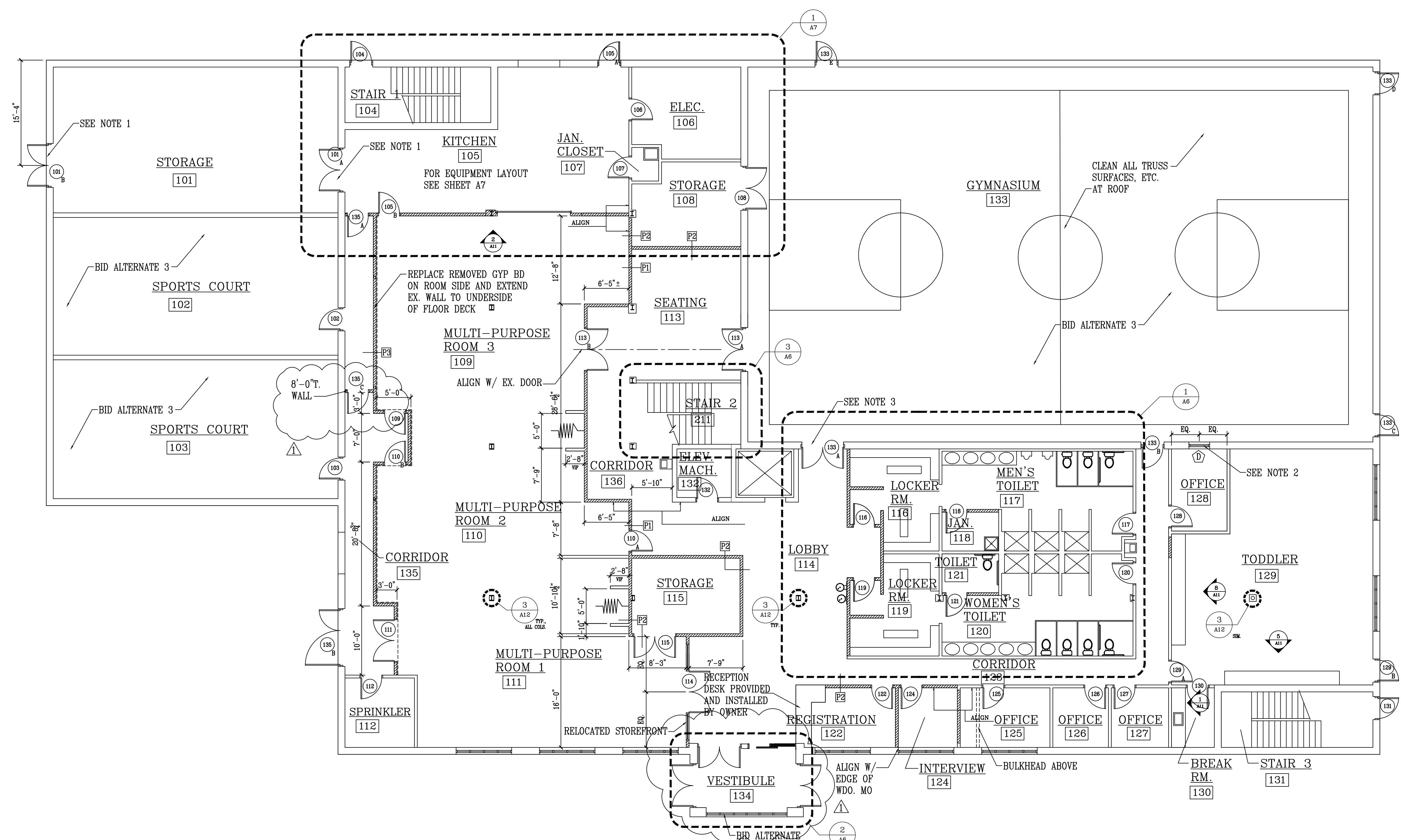

1 COMPOSITE PLAN - FIRST FLOOR  
1/8" = 1'-0"

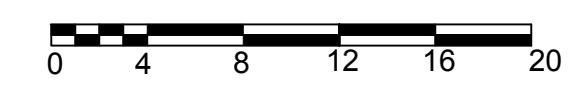

REVISIONS
10-1-18

**MODIFICATIONS TO WALDORF SENIOR & RECREATIONAL CENTER**  
CHARLES COUNTY, MARYLAND

**R.L. LITTEN & ASSOCIATES, ARCHITECTS, LLC**  
300 CHARLES STREET, SUITE 4  
P.O. BOX 1920, LAPLATA, MD 20646 (301) 934-1471

KL
RL
7-2-18
17-32
A4

I CERTIFY THAT THESE DOCUMENTS WERE PREPARED OR APPROVED BY ME, AND THAT I AM A DULY LICENSED ARCHITECT UNDER THE LAWS OF THE STATE OF MARYLAND. LICENSE NUMBER 7659. EXPIRATION DATE DECEMBER 31, 2019.

COPYRIGHT © LITTEN & ASSOCIATES, ARCHITECTS, LLC. NO PART OF THIS DRAWING MAY BE REPRODUCED, STORED OR TRANSMITTED IN ANY MANNER WITHOUT PRIOR WRITTEN PERMISSION FROM THE ARCHITECT.