

KITCHEN PART PLAN - POWER-NEWWORK
SCALE: 1/8"=1'-0"

KITCHEN EQUIPMENT SCHEDULE - ELECTRICAL

Item No.	Equipment	Manufacturer	Model No.	Remarks	VOLTAGE	AMPS	CONNECTION
(1)	Coffee Um	Cecilware	FE100N		120/208V 1PH	29.0	NEMA L6-30R
(2)	Freezer	Central Restaurant Products	69K-605		120V 1PH	13.8	NEMA 5-20R
(3)	Refrigerator	Central Restaurant Products	69K-602		120V 1PH	7.2	NEMA 5-20R
(4)	Dishwasher	Hobart	LT-1		120V 1PH	13.8	HARD-WIRED
(5)	Ice Machine	Manitowoc	UD-0190A		120V 1PH	5.5	NEMA 5-20R
(6)	Electric Convection Oven	Vulcan	VC55E	With casters	120V 1PH	8.0	NEMA 5-20R (2)
(7)	Heated Serving Counter	Shelleyglas	KH-4-NU	With tray slides & food shields	120V 1PH	10.0	NEMA 5-20R
(8)	Cold Pan Serving Counter	Shelleysteel	SCSC-60-EF	With tray slides & food shields	120V 1PH	12.0	NEMA 5-20R

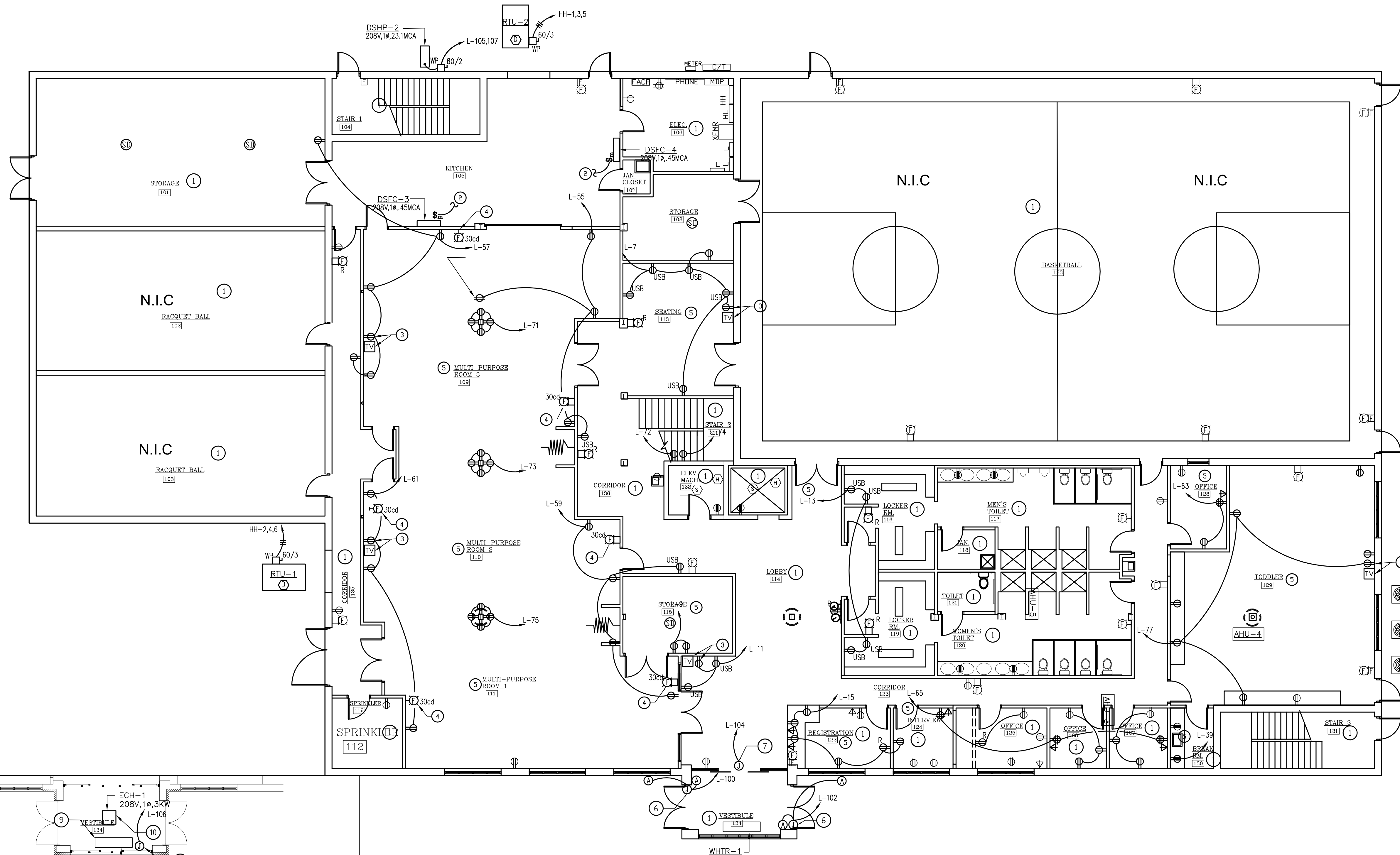

FIRST FLOOR PLAN -POWER- NEW WORK
SCALE: 1/8"=1'-0"

GENERAL NOTE:

CONTRACTOR SHALL VERIFY ALL EXISTING CIRCUITS IN AREAS WHERE DEMOLITION WAS DONE. REUSE ALL EXISTING CIRCUITS PRIOR TO RUNNING NEW CIRCUITS BACK TO EXISTING PANELBOARD.

DRAWING NOTES:

- ALL EXISTING LIGHTING, SWITCHES, AND ASSOCIATED WIRING IN THIS AREA SHALL REMAIN UNLESS OTHERWISE NOTED.
- CONNECT INDOOR FAN UNIT TO DESIGNATED HEAT PUMP UNIT ON ROOF. REFER TO MANUFACTURER'S INSTRUCTIONS FOR CONNECTIONS.
- CONTRACTOR SHALL PROVIDE A DUPLEX RECEPTACLE AND TELEVISION OUTLET AT 8" A.F.F. FOR TELEVISION. PROVIDE RG-6 COAXIAL CABLE TO LOCATION AS DIRECTED IN FIELD.
- CONTRACTOR SHALL PROVIDE A NEW FIRE ALARM NOTIFICATION DEVICE AS INDICATED. CONNECT TO EXISTING FIRE ALARM SYSTEM LOCATED IN MAIN ELECTRICAL ROOM. NEW DEVICES SHALL MATCH AND BE COMPATIBLE WITH EXISTING FIRE ALARM SYSTEM.
- CONTRACTOR SHALL VERIFY ALL EXISTING LIGHTING CIRCUITS IN THIS AREA FROM DEMOLITION PRIOR TO RUNNING NEW CIRCUITS TO EXISTING PANEL "L".
- CONTRACTOR SHALL PROVIDE A 120V CONNECTION TO AUTOMATIC DOORS OPERATOR AND ASSOCIATED ACTUATORS AS INDICATED. CONTRACTOR SHALL MAKE ALL FINAL CONNECTION FOR A COMPLETE AND FUNCTIONAL SYSTEM.
- CONTRACTOR SHALL PROVIDE A 120V CONNECTION TO AUTOMATIC SLIDING DOORS OPERATOR AS INDICATED. CONTRACTOR SHALL MAKE ALL FINAL CONNECTION FOR A COMPLETE AND FUNCTIONAL SYSTEM.
- CONTRACTOR SHALL PROVIDE A 120V CONNECTION TO AUTOMATIC SLIDING DOOR OPERATOR AS INDICATED. CONTRACTOR SHALL MAKE ALL FINAL CONNECTION FOR A COMPLETE AND FUNCTIONAL SYSTEM. THIS WORK SHALL BE DONE UNDER BID ALTERNATE 1
- CONTRACTOR SHALL REMOVE EXISTING CIRCUIT FEEDING WHTR-1 AND RETAIN FOR CONNECTION TO NEW ECH-1 MOUNTED IN CEILING.
- CONTRACTOR SHALL CONNECT EXISTING CIRCUIT FROM DEMOLITION OF WHTR-1 TO NEW ECH-1.

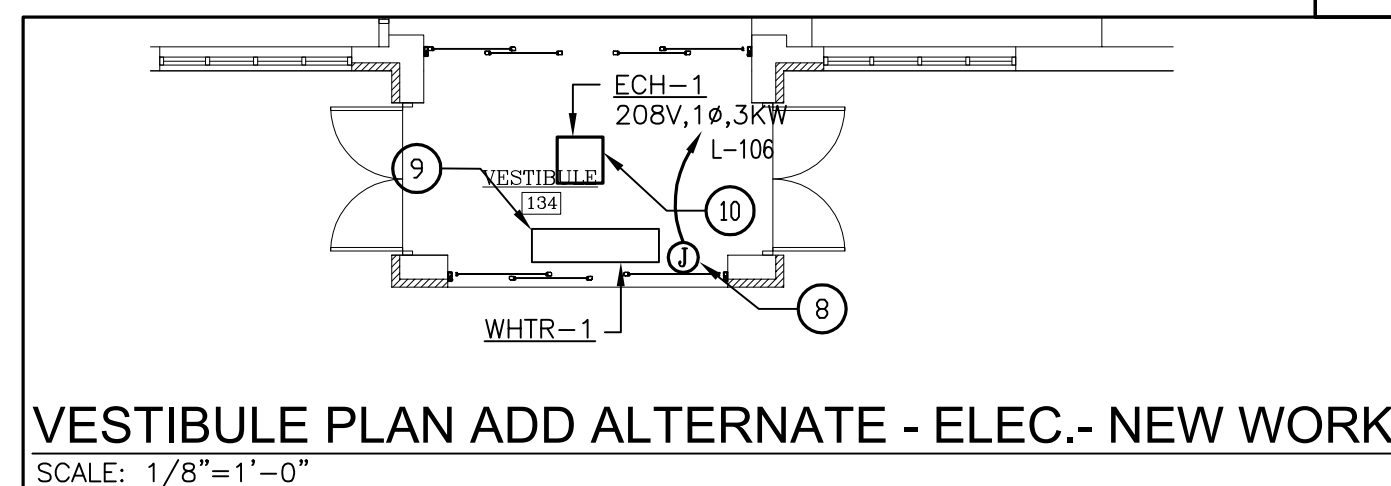

VESTIBULE PLAN ADD ALTERNATE - ELEC.- NEW WORK
SCALE: 1/8"=1'-0"

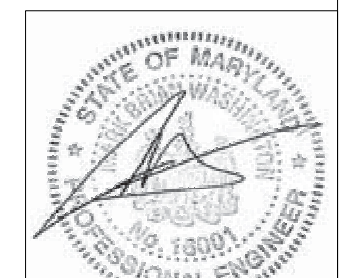

PROFESSIONAL CERTIFICATION
I hereby certify that these documents were prepared or approved by me, and that I am a duly licensed professional engineer under the laws of the State of Maryland, License No. 16001, Expiration Date: 4/26/20

Johnson Consulting Engineers, Inc.
130 W. 25th Street Baltimore, Maryland 21218
Tel: (410) 235-0057, Fax: (410) 235-0946
Email: info@jceengineers.net

REVISIONS

MODIFICATIONS TO WALDORF SENIOR & RECREATIONAL CENTER
 CHARLES COUNTY, MARYLAND
COPYRIGHT BY LITTEEN & ASSOCIATES, ARCHITECTS, LLC. NO PORTION OF THIS DRAWING MAY BE REPRODUCED, STORED OR TRANSMITTED BY ANY MEANS WITHOUT PRIOR WRITTEN PERMISSION FROM THE ARCHITECT.

R.L. LITTEEN & ASSOCIATES, ARCHITECTS, LLC
 300 CHARLES STREET, SUITE 4
 P.O. BOX 1920, LAPLATA, MD 20646 (301) 934-1471

DRAWN BY: MDJ
 CHK'D BY: RMM
 PROJECT No. 2018

E3

(PERMIT SET 7-26-18)